

GENERAL NOTES

The Developer/Contractor/Builder is to ensure that the building under construction/alteration is to comply where applicable with the 2010 Building Regulations in respect of all trades involved in the construction of this development.

The Developer/Contractor/Builder should notify BCA of any intended deviations from these plans prior to commencement of development.

All Site Development works to be carried out in accordance with "Recommendations for Site Development Works for Housing Areas" Dept. of Environment.

Contractors must verify all dimensions at the job before commencing any work. No working dimensions to be scaled. This drawing is for the purpose of planning only. Dimensions to blockwork only.

Revision

Date	Rev.

NOTE: REFER TO HOUSING MIX STATEMENT FOR ALL RELEVANT ROOM AREAS

NOTE: REFER TO SITE LAYOUT (18002 301) FOR NORTH ORIENTATION AND F.F.L.'S. (F.F.L.'S SHOWN ARE FROM LOCAL GROUND LEVEL AS INDICATED ON SITE LAYOUT)

SELECTED BRICK COLOUR TO BE DEFINED BY CHARACTER ZONING.

REFER TO CHARACTER ZONING MAP FOR FURTHER INFORMATION (18002 305)

* ALL DWELLINGS TO COMPLY WITH BUILDING REGULATIONS PART L 2011 (CONSERVATION OF FUEL AND ENERGY)

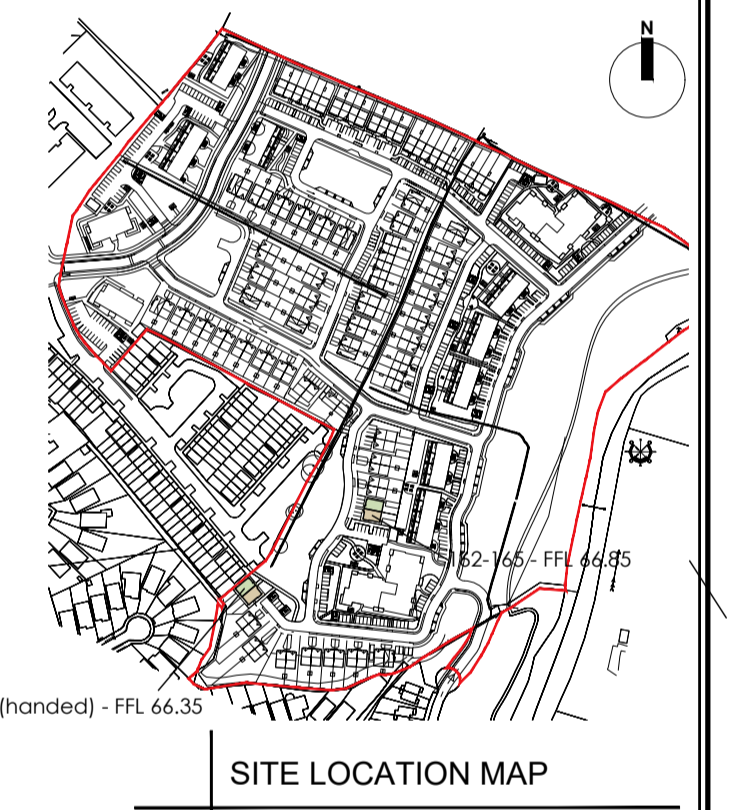
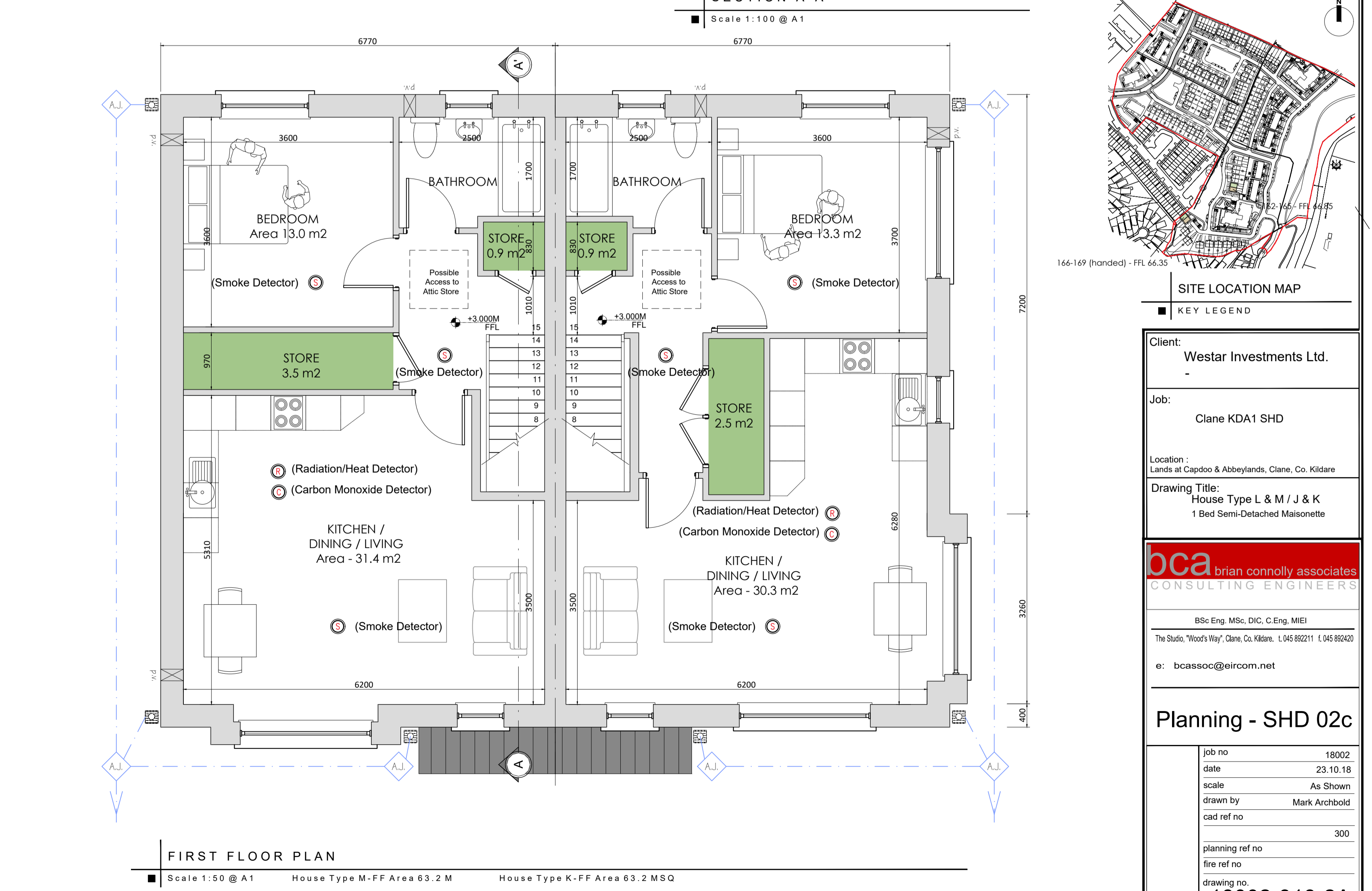
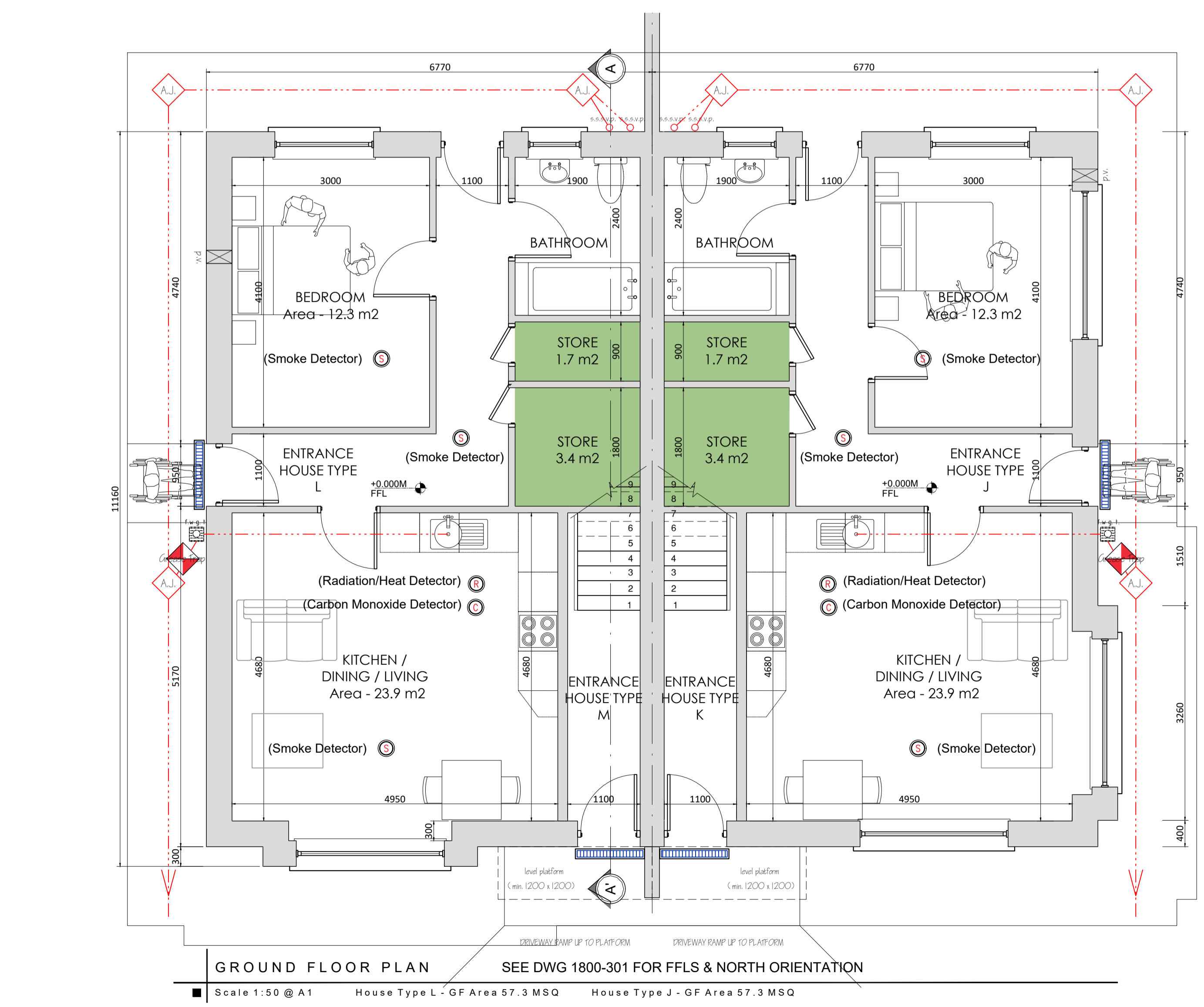

SITE LOCATION MAP

KEY LEGEND

Client: Westar Investments Ltd.

Job: Clane KDA1 SHD

Location: Lands at Capdoo & Abbeylands, Clane, Co. Kildare

Drawing Title: House Type L & M / J & K
1 Bed Semi-Detached Maisonette

oca brian connolly associates
CONSULTING ENGINEERS

BSc Eng. MSc, DIC, C.Eng. MIEI
The Studio, 'Wood's Way', Clane, Co. Kildare. L045 892211 | 045 892420
e: bcassoc@eircom.net

Planning - SHD 02c

job no	18002
date	23.10.18
scale	As Shown
drawn by	Mark Archbold
cad ref no	
	300
planning ref no	
fire ref no	
drawing no.	18002-318-2A